

SECURITY FROM THE INSIDE

Internal waterproofing and tanking

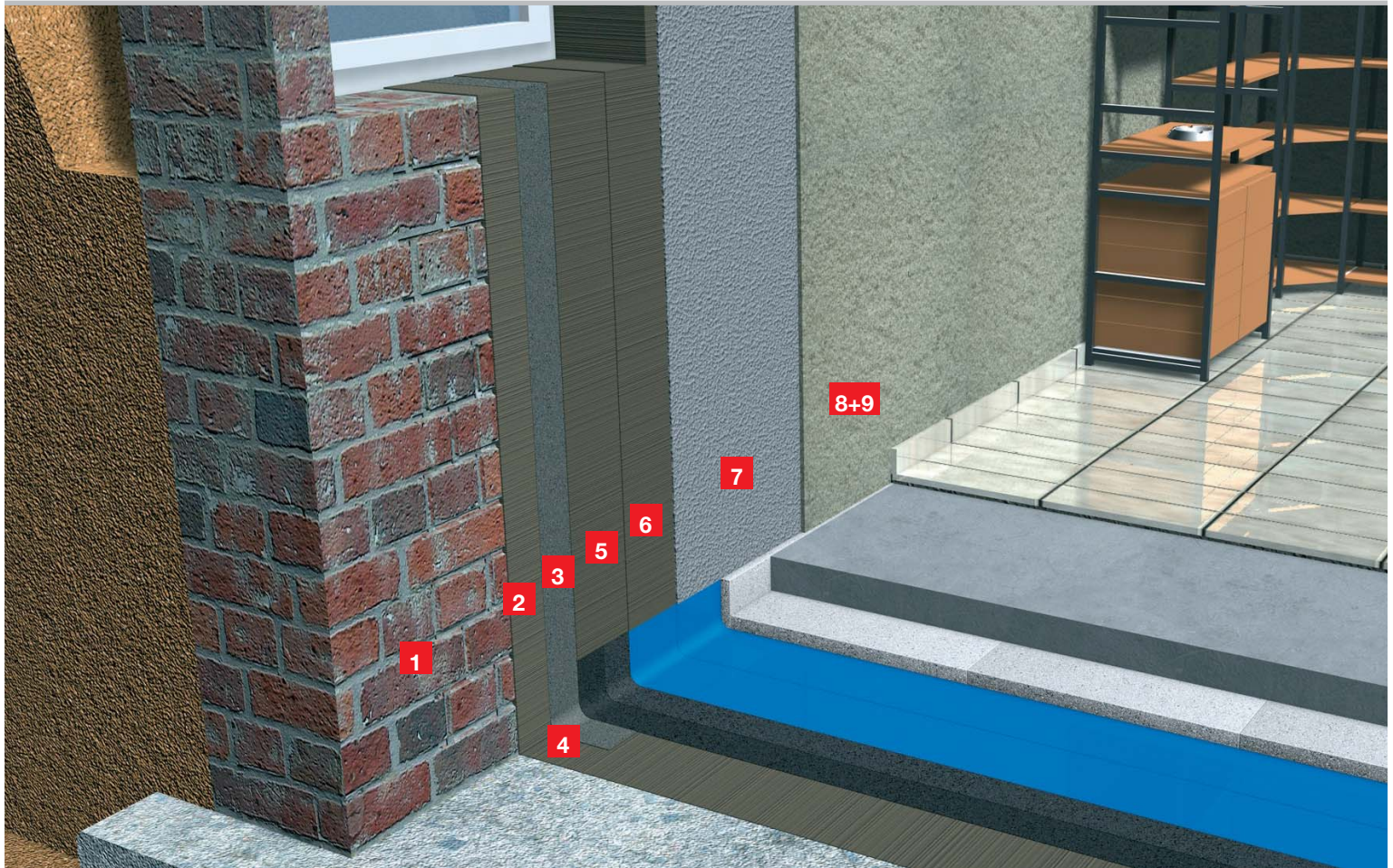



FROM A GOOD FOUNDATION TO THE FINISHING PLASTER

Internal waterproofing and tanking – The Kiesol system

The Kiesol systems can be installed on almost any masonry substrate.

The right procedure for the application of internal waterproofing always begins with sound substrate preparation.

All loose or friable materials, including

any old coatings or other contaminants, must be removed. Paints and plasters must be removed for at least 80 cm above the water damaged areas. Joints that have deteriorated or are damaged by salts, must be raked out to a minimum depth of 20 mm. When the substrate is

correctly prepared, a clean and roughened masonry surface is provided. The adhesion between the individual components of the Kiesol system is outstanding and the system as a whole, bonds effectively and durably with the masonry.

HOW THIS TYPE OF WATERPROOFING IS ACHIEVED

The sequence of operations



PRIMING WITH KIESOL

Priming the prepared substrate with Kiesol. Highly absorbent substrates are pre-dampened first.



BOND COAT WITH SULFATEX GROUT

Within the Kiesol open time, the Sulfatex Grout bond coat is applied by brush.



LEVELLING WITH WATERPROOFING FILLER

The Waterproofing Filler is trowel applied on the wet bond coat, if required.



SEALING COVE WITH WATERPROOFING FILLER

The sealing cove is formed with the Waterproofing Filler, using a special coving trowel.



THE 1ST WATERPROOFING LAYER WITH SULFATEX GROUT

The 1st layer of waterproofing slurry is applied on the bond coat and levelling/coving layers.



THE 2ND WATERPROOFING LAYER WITH SULFATEX GROUT

The 2nd layer of slurry is applied on the 1st layer 'wet on wet'. Additional layers if required for the exposure conditions are applied in the same way 'wet on wet'.



APPLY THE 'SPRITZ' BOND COAT

This 'Spritz' Bond Coat is sprayed over the entire surface of the slurry, once it has initially stiffened.



RESTORATION RENDER APPLICATION

The Restoration Render is applied after 24 to 48 hours.



RESTORATION RENDER FINISHING

After its initial set, the Restoration Render must be 'finished' by rubbing over with a float and a little water or scratching ready for covering with covering with Fine Render.

CHARACTERISTICS THAT MAKE THE KIESOL SYSTEM SO STRONG

1. Kiesol is an environmentally friendly, water based system and is therefore suitable for use in living areas, archives, and swimming pools and even in drinking water tanks.
2. Kiesol develops water repelling consolidation of the substrate for upgrading old waterproofing systems and injection systems against rising capillary damp etc.
3. Silicification and silica gel formation within the substrate, restrict capillary action and are therefore also water repellent.
4. Because the pore structure is not fully sealed, the system remains water vapour diffusible, unless specifically sealed with Remmers coatings (to meet BS 8102:1990 Grade 4 for example – waterproof and vapourtight).
5. Dissolved mineral salts transport to the surface is inhibited and the salts are bound within the system.
6. All of the slurry, levelling and mortar systems are highly sulphate resistant.
7. The excellent bond of and between each of the individual system components, guarantees maximum security, even on extremely damp substrates.
8. Ideal application characteristics, both manually and by spray, provide exceptional economy.
9. The slurry sealant setting process starts immediately the system is applied; this accelerated setting saves time and allows “wet on wet” working.
10. The substrate surface chemical resistance is increased to a ‘high’ classification (according to DIN 4030).
11. Over 50 years of successful and practical experience, with numerous system assessments, test certificates and research reports guarantee maximum security and durability for Remmers customers and their clients.

714/05.07 GB

**Remmers (UK) Limited Crawley
United Kingdom**

Tel.: +44(0) 845 373 0103

Fax: +44(0) 845 373 0104

www.remmers.co.uk

**Remmers (Far East) Pte. Ltd.
Singapore**

Tel.: +65 6 7410277

Fax: +65 6 7417158

